

MUNDELEIN SCHOOL DISTRICT CLASSROOMS

Mobile Modular worked with the Mundelein School district to accommodate an influx of students while saving money for future construction.

THE BACKGROUND AND CHALLENGE

Beginning in 1950, the Washington Early Learning Center in Mundelein School District 75 built out its kindergarten through second-grade program in four phases, but the space had once again met capacity.

With an anticipated increase as the result of a new subdivision being built nearby, along with knowing that the upcoming group of kindergartners could fill more classes than they had space for when 15-20 special education students were already being bussed to another district, a space solution was needed. The district started by looking into building a new wing through permanent construction, but the cost of four classrooms was estimated at over \$3 million.

When the district analyzed and saw they could build a corridor rather inexpensively to connect the existing school to a modular classroom building, they decided it would alleviate parents' concerns about safety and teachers' concerns about lost construction time.

Contact Us Today!

866.889.7777 • mobilemodular.com

Customer Name: Mundelein School District

Project Location: Lake County, IL

Building Type(s): Modular Classrooms

Job Type: Sale

Total Sq. Ft.: 8,500 sq. ft.

THE SOLUTION

Mobile Modular provided a modular building that consisted of eight classrooms and complete restroom facilities for the students, faculty, and custodial staff. The buildings have heating, air conditioning, and internet throughout. The walls feature extra insulation for soundproofing and protection against the elements.



BUILDING LAYOUT

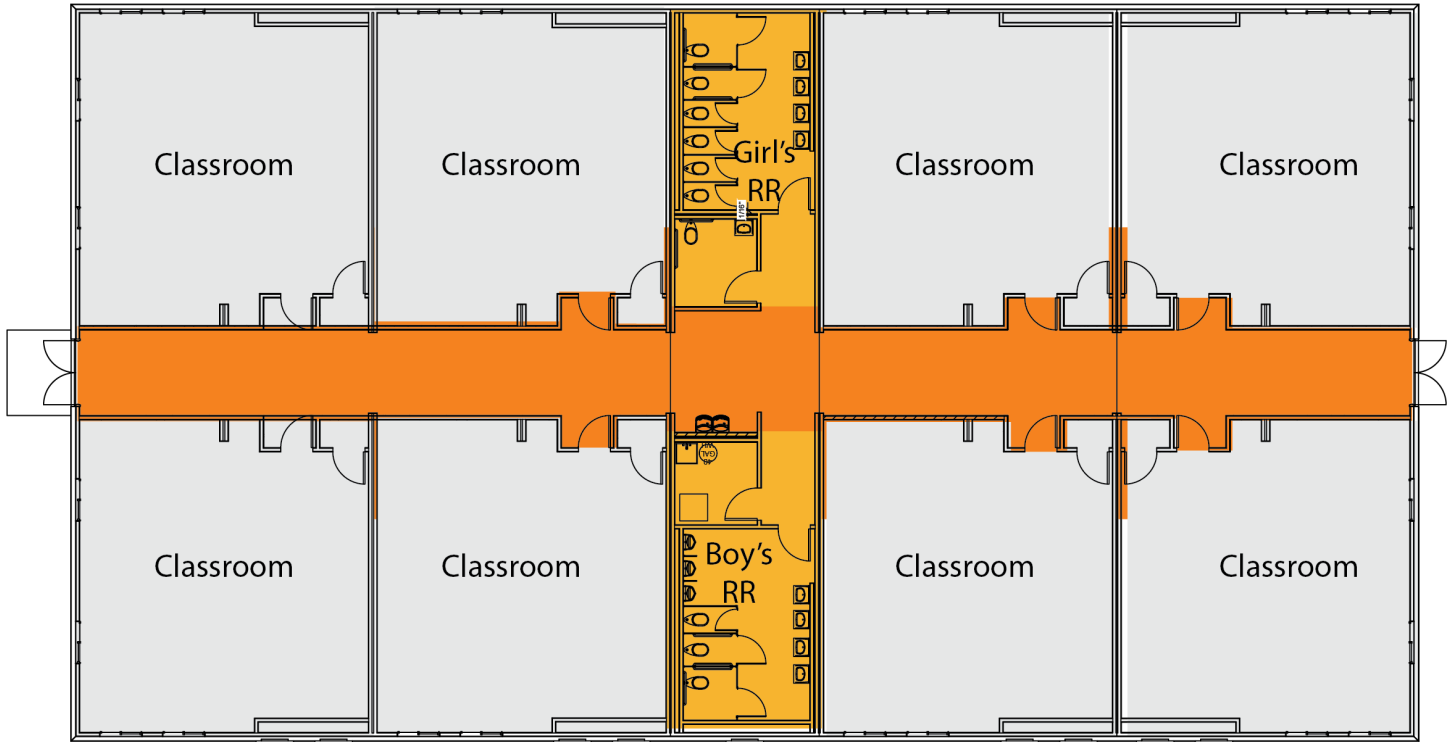

Contact Us Today!

866.889.7777 • mobilemodular.com

