

MARTHA'S VINEYARD CLASSROOMS

Mobile Modular provided the remote location of Martha's Vineyard with 32 modules to provide new classrooms

THE CHALLENGE

The proposed bid would seek out 4 modular classroom buildings with a total of 28 classrooms to provide a place for the students to continue learning for the duration of the 20-month renovation of their classrooms. Additionally, the selected vendor would need the capacity to barge the 32 modules through the bay from New Bedford, MA.

THE SOLUTION

The Mobile Modular team worked with the architect, Tappe Architects, and the construction manager, W.T. Rich Company, to design and construct the extra space for the end user, the Town of Tisbury on Martha's Vineyard, during their renovations. The architect assisted in designing floor plans based on the specifications we provided to meet the town's needs as well as be marketable to future Mobile Modular customers once the lease is concluded. At the end of construction, there were (3) 124' x 60' and (1) 68' x 60' modular classroom buildings, housing 28 classrooms, delivered and assembled in the Town of Tisbury. Through the bidding process, Mobile Modular acquired and strengthened relationships with local vendor trades based on the island to help ensure we would be able to overcome the largest obstacle of the project, the remote location.

Customer Name: Town of Tisbury, MA

Project Location: Martha's Vineyard, MA

Building Type(s): Modular Classrooms

Job Type: Lease

Total Sq. Ft: 26,400 sq. ft.



Contact Us Today!

866.889.7777 • mobilemodular.com



BUILDING LAYOUT

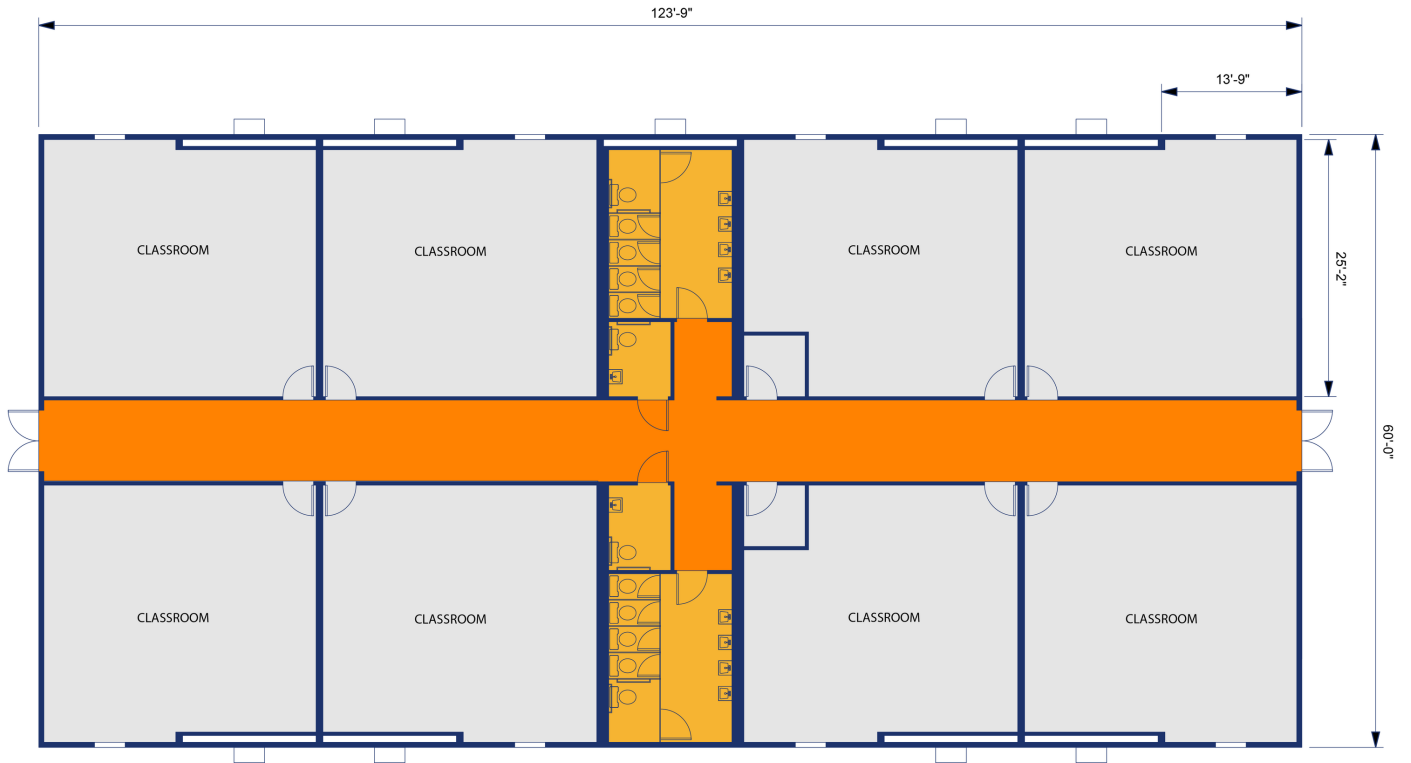

Contact Us Today!

866.889.7777 • mobilemodular.com

